

Installation

FP devices are mounted as follows (see Fig. 1)

- Hook the earthing clamp at the protected side of the base of the FP unit over one flange of the DIN rail (1).
- Press down the unprotected area end of the FP unit firmly until it clicks into position (2).
- Check that the FP unit is securely clamped into place on both field and protected sides.

Note: It is essential to check that the earth connection has been made securely.

- To remove, insert the blade of a screwdriver down the unprotected side of the FP unit (3) and lever the handle gently towards the FP unit (4) and upwards to disengage the spring, freeing the unit from the rail (5).
- When connecting the signal wires, if using an electric screwdriver the torque setting should be between 0.4 and 0.6Nm.

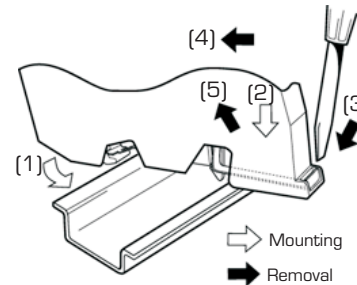
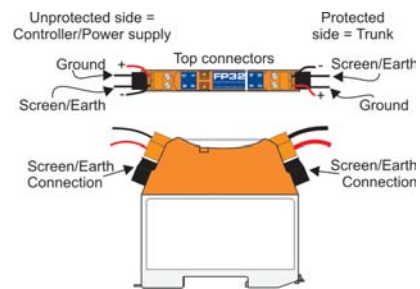

Fig. 1 - Mounting/removing an FP unit

FP32 Installation Guide



The unit is polarised, as shown above.

For full surge protection the DIN rail mounting must be earthed (via the DIN rail or the screw connection).

There are screen options:

Through screen not earthed at this point

Use the two S connections on the lower connectors;

Screen earthed at this point

Use the two  connections on the lower connectors.

For full protection the unit must be connected so that the surge is expected on the unprotected side. The unit will then protect the devices on the protected side.

Earthing

Correct earthing procedures are essential for effective and safe surge protection. Each FP unit has its earth connection made onto the DIN rail or screw terminal. Connection to the surge earth is made using an ETL earth terminal clamped to the DIN rail at either, or preferably both ends of a row of FP surge protectors.

- Locate the earth terminal next to the FPs at the end of the row or connect directly to the screw terminal on the ground foot located on the protected side.
- Hook the earthing clamp over the flange of the DIN rail. Press down the other end of the terminal until it locates over the DIN rail. Firmly tighten the clamping screw in the central hole on top of the terminal. Check that the earth terminal is properly clamped to ensure that the earth connection has been made securely.
- The earth connection of the FP should be made to the earth reference of the equipment to be protected. In practice, the earth connection is usually made to the OV reference earth box in the equipment cubicle. The earth connection should be 1 metre in length and use wire size 2.5mm².

Note: The overall earthing system is critical to effective operation of the surge protector. This may require re-routing of the system earthing and the installation instructions should be checked carefully.

FP Series Fieldbus Trunk SPD

