

Finger Clamp Component Assembly

Stainless steel finger clamps allow a standard ISO-KF flange to be attached directly to a Genesis valve or fitting using a standard ISO-KF centering ring and O-ring. Elbows, reducers, chamber ports, roughing lines, or other vacuum components can be attached directly to valve bodies or fittings with finger clamps. Unnecessary valve ports have been eliminated, shortening the gas path and increasing system conductance. For ultimate versatility standard nipples and elbows can be attached with finger clamps in order to make a drop-in replacement valve, such as an angle-in-line or tee valve. Once the finger clamp bolt is loosened it can be pivoted out of the way in order to remove or install the flange and centering ring. The finger clamp does not need to be removed from the valve or fitting. The clamp is self-aligning when tightened, for ease of flange installation. Each kit contains four finger clamps, hex head bolts and washers for one connection.

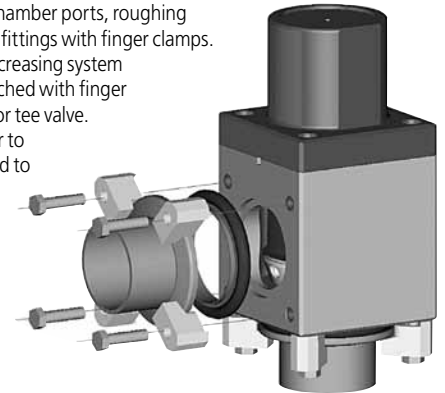
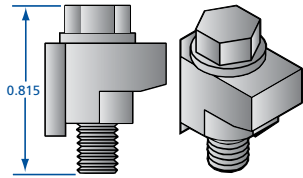

MODEL NUMBER	VALVE SIZE	BOLT	TORQUE
GNCP-150-S	$\frac{3}{4}$ to $1\frac{1}{2}$	12-24 x $\frac{7}{8}$	60 in/lb
GNCP-200-S	2	$\frac{1}{4}$ -20 x $\frac{7}{8}$	100 in/lb

Block Subassemblies with Double Stud Fasteners

Stainless steel double stud fasteners allow two Genesis components to be connected using a standard ISO-KF centering ring and O-ring. Special subassemblies, such as diverter valves or roughing/high vacuum circuits can be assembled quickly using double stud fasteners with valves and block fittings. These subassemblies can be provided as a unit from Nor-Cal or you may choose to assemble them from individual components. They are ideal for limited space installations, such as on cluster tool frames, and provide highest conductance, while eliminating unnecessary hardware. Double stud fasteners can be used to make a bulkhead attachment from a valve directly to a chamber. Stud fasteners can be installed using a jeweler's screwdriver and a $\frac{3}{8}$ inch ignition wrench. An installation tool for stud fasteners is provided with each stud fastener kit or assembly, or one can be purchased separately. Each kit contains four double stud fasteners for one connection and an installation tool.

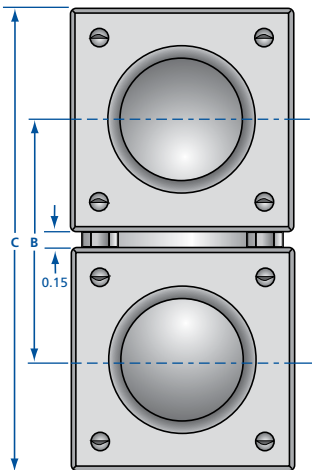
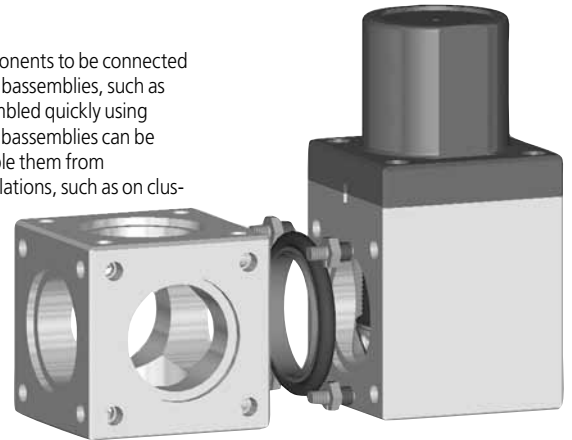
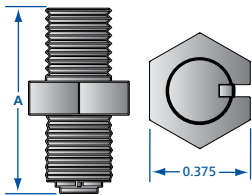

MODEL NUMBER	VALVE SIZE	DESCRIPTION	THREAD	A	B	C
GNSF-150	$\frac{3}{4}$ to 1	(4) double stud fasteners	12-24	0.625	2.28	4.40
GNSF-150	$1\frac{1}{2}$	(4) double stud fasteners	12-24	0.625	2.65	5.15
GNSF-150-K	$\frac{3}{4}$ to $1\frac{1}{2}$	(4) double stud fasteners with install tool	12-24	0.625	-	-
GNSF-200	2	(4) double stud fasteners	$\frac{1}{4}$ -20	0.730	3.40	6.65
GNSF-200-K	2	(4) double stud fasteners with install tool	$\frac{1}{4}$ -20	0.730	-	-
GNSF-T	All	Double stud install tool	-	-	-	-